

# NOVA

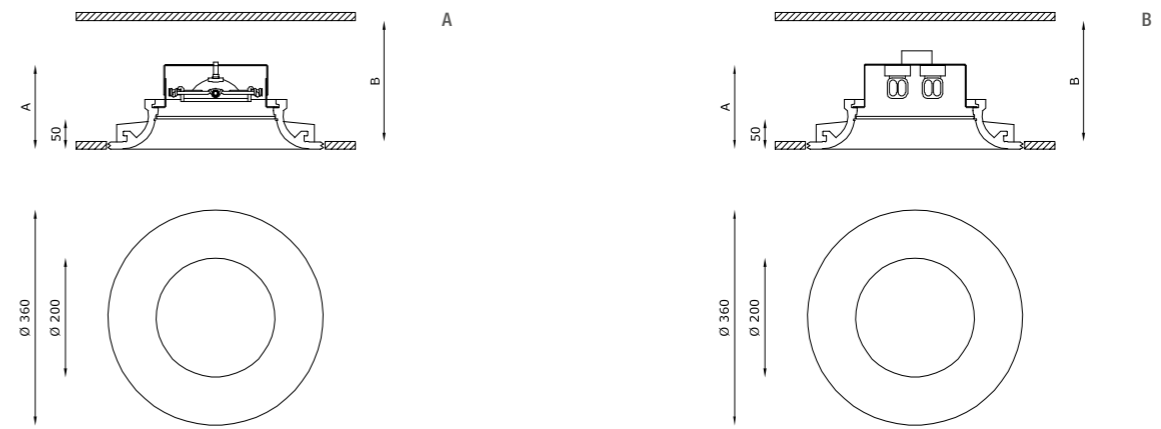

Un incasso a scomparsa totale da interni in AirCoral® per installazione in soffitto di cartongesso caratterizzato da un foro luce stondato in grado di donare grande plasticità al soffitto. Il fascio luminoso creato da Nova accentua l'effetto di morbidezza delle superfici su cui è installato e degli ambienti.

*This indoor recessed lighting system made of AirCoral® has a rounded light hole and a total disappearance effect into plasterboard ceilings able to give great plasticity to the ceiling. The light created by Nova emphasizes the smooth effect given by the surfaces it is installed on.*



## TECHNICAL FEATURES

Code	5271.AC (fig. A)	5278.AC (fig. B)	5276.AC (fig. B)	5277.AC (fig. B)	5285.AC (fig. B)
Type	Tiltable downlight +/- 30° 	Downlight 90° 	Downlight 90° 	Downlight 90° 	Downlight 90° 
Material	AC: AirCoral®	AC: AirCoral®	AC: AirCoral®	AC: AirCoral®	AC: AirCoral®
Absorption capacity*	8.92 m²	8.92 m²	8.92 m²	8.92 m²	8.92 m²
Weight	5.5 Kg	5.3 Kg	5.6 Kg	5.6 Kg	5.8 Kg
Mounting	Ceiling recessed	Ceiling recessed	Ceiling recessed	Ceiling recessed	Ceiling recessed
IP rating	IP40	IP40	IP40	IP40	IP40
Insulation class	III	I	I	I	I
Control gear	Dimmable electronic transformer	-	Electronic ballast	Electronic ballast	Electronic ballast
Dimensions	A: 165 mm; B: 250 mm	A: 165 mm; B: 230 mm	A: 165 mm; B: 250 mm	A: 165 mm; B: 250 mm	A: 180 mm; B: 250 mm
Cut out for plasterboard	Ø 370 mm	Ø 370 mm	Ø 370 mm	Ø 370 mm	Ø 370 mm
Lamp type	QR 111 	QT-DE12 (75 mm) 	TC-TEL 	TC-TEL 	TC-TEL 
Lamp wattage	100W max	150W max	2 x 26/32W	2 x 42W	2 x 26W
Luminous efficacy	-	-	-	-	-
Light distribution	-	-	-	-	-
Fitting	G53	R7s	Gx24q-3	Gx24q-4	Gx24q-3
Light colour	-	-	-	-	-
Light hole	Ø 200 mm	Ø 200 mm	Ø 200 mm	Ø 200 mm	Ø 200 mm
Voltage connection	220-240V / 12V 50/60Hz	220-240V 50/60Hz	220-240V 50/60Hz	220-240V 50/60Hz	220-240V 50/60Hz
CRI	-	-	-	-	-
Emergency	-	-	-	-	1 hour
Energy efficiency class	A	A+	A+	A+	A+
Note	Extra white satin glass. Frosted glass recessed 50 mm into the ceiling.	Extra white satin glass. Frosted glass recessed 50 mm into the ceiling.	Extra white satin glass. Frosted glass recessed 50 mm into the ceiling.	Extra white satin glass. Frosted glass recessed 50 mm into the ceiling.	Extra white satin glass. Frosted glass recessed 50 mm into the ceiling.

## OPTIONAL ACCESSORIES

product code	optional code	description	info
5271.AC	00010KIT	Kit LED dimmable	Bulb 10W · 12V

\* The absorption capacity per m² calculated by the American organization TCNA (Tile Council of North America) is measured for an average room of 2,7 m in height and therefore expressed in m²







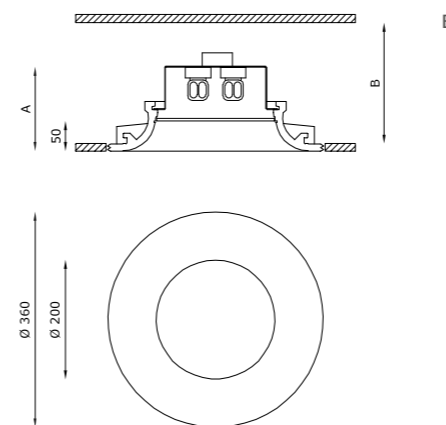

Bar I Mulini - ph- G. Doppiu - Cagliari



TECHNICAL FEATURES

Code	5286.AC (fig. B)	5287.AC (fig. B)	5296.P.AC (fig. B)	5291.AC (fig. B)	5293.AC (fig. B)
Type	Downlight 90°	Downlight 90°	Downlight 90°	Downlight 90°	Downlight 90°
Material	AC: AirCoral®	AC: AirCoral®	AC: AirCoral®	AC: AirCoral®	AC: AirCoral®
Absorption capacity*	8.92 m²	8.92 m²	8.92 m²	8.92 m²	8.92 m²
Weight	5.8 Kg	5.8 Kg	5.9 Kg	6.8 Kg	5.8 Kg
Mounting	Ceiling recessed	Ceiling recessed	Ceiling recessed	Ceiling recessed	Ceiling recessed
IP rating	IP40	IP40	IP40	IP40	IP40
Insulation class	I	I	I	I	I
Control gear	Electronic ballast	Electronic ballast	Dimmable electronic ballast	Constant current electronic driver	Dimmable constant current driver
Dimensions	A: 180 mm; B: 250 mm	A: 180 mm; B: 250 mm	A: 165 mm; B: 250 mm	A: 200 mm; B: 220 mm	A: 170 mm; B: 220 mm
Cut out for plasterboard	Ø 370 mm	Ø 370 mm	Ø 370 mm	Ø 370 mm	Ø 370 mm
Lamp type	TC-TEL 	TC-TEL 	TC-TEL 	LED 1050 mA 	LED 350 mA 
Lamp wattage	2 x 32W	2 x 42W	2 x 42W	1 x 40W	2 x 6.5W
Luminous efficacy	-	-	-	107 lm/W - 3000K	2 x 810 lm - 3000K
Light distribution	-	-	-	Wide beam 40°	Wide beam 120°
Fitting	Gx24q-3	Gx24q-4	Gx24q-4	-	-
Light colour	-	-	-	White 3000K White 2700K   4000K (on request)	White 3000K White 2700K   4000K (on request)
Light hole	Ø 200 mm	Ø 200 mm	Ø 200 mm	Ø 200 mm	Ø 200 mm
Voltage connection	220-240V 50/60Hz	220-240V 50/60Hz	220-240V 50/60Hz	220-240V 50/60Hz	220-240V 50/60Hz
CRI	-	-	-	>80 >90 (on request)	>80
Emergency	1 hour	1 hour	-	-	-
Energy efficiency class	A+	A+	A+	A++	A+
Note	Extra white satin glass. Frosted glass recessed 50 mm into the ceiling.	Extra white satin glass. Frosted glass recessed 50 mm into the ceiling.	Extra white satin glass. Frosted glass recessed 50 mm into the ceiling.  Standard: dimmable switch dim. / push (on request: dimmable 1-10V or DALI).	Extra white satin glass. Frosted glass recessed 50 mm into the ceiling.	Extra white satin glass. Frosted glass recessed 50 mm into the ceiling.  Trailing-edge and leading-edge dimming (20 - 100%).