

# N-INSIDE

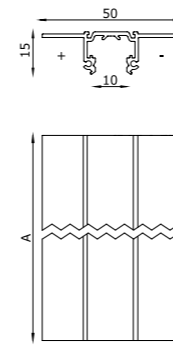

## LIGHT MODULES

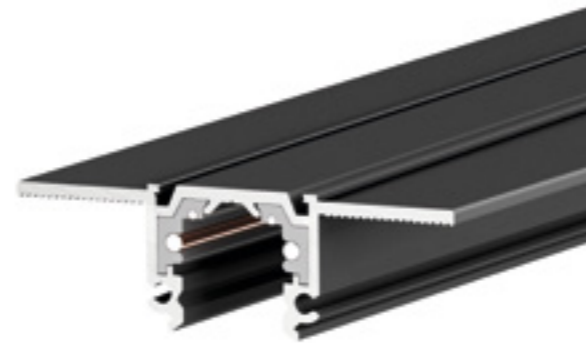

L1 NANO 48V 112    THE TUBE NANO 48V 114    U1 NANO 48V 104



X1 NANO 48V 106    Y1 NANO 48V 108    Z1 NANO 48V 110

Sistema di illuminazione da interno per installazione a incasso. Binario e corpi sono gestibili con sistemi di controllo remoto DALI e 1-10V. Il profilo ha lunghezza compresa fra 1 m e 3 m, estruso in alluminio nero e dotato di conduttori 48V.

N-INSIDE a 48V si completa a sua volta con tutti i prodotti di illuminazione Buzzi & Buzzi dotati di attacchi con un'elettronica integrata. È vietato utilizzare alimentatori, driver, sistemi Bus Dati e componenti non omologati SELV e/o che abbiano una U-OUT > 60Vdc.

Si raccomanda l'utilizzo di un ripetitore optoisolato DALI compatibile per rendere compatibile un comando FELV in SELV (vedi codice: T048 A 00078 00).

*A lighting system for interiors for recessed installation. The track and structures can be managed by remote DALI and 1-10V systems. The profile is between 1 m and 3 m long, extruded in black aluminium and fitted with 48V leads.*

*In turn, the 48V N-INSIDE is completed with all the Buzzi & Buzzi lighting products fitted with connections with integrated electronics. The use of NON SELV or U-OUT > 60Vdc power supplies, drivers and components is strictly forbidden.*

*Is recommended the usage of an opto-insulated repeater DALI to convert FELV into SELV ( code: T048 A 00078 00).*

## CODE COMPOSITION

T048 T 05 B1 0\_1

	length
01	1000 mm
02	2000 mm
03	3000 mm

example of code composition    T048 T 05 B1 0 01 1

## TECHNICAL FEATURES

Code	T048 T 05 XX
Type	Low voltage track
Material	Aluminum
Finishing	Black
Weight	-
Mounting	Recessed
IP rating	-
Insulation class	III
Control gear	Remote power supply (not included)
Dimensions	A: 1000 mm   2000 mm   3000 mm
Cut out for plasterboard	21 mm x A
Voltage connection	48 VDC
Circuits	2 x ±10 A · 48 VDC 1 x ±10 A · 48 VDC + D+/D
Note	The supply connectors, plugs and further fixture accessories must be ordered separately.  Any 90° connector must be ordered separately to ensure electric continuity in the corners.  Light points cannot be installed in the corners.

**TESTATA  
DI ALIMENTAZIONE**  
POWER HEAD



CODE COMPOSITION

T048 A 00095 B1

TECHNICAL FEATURES

<b>Code</b>	<b>T048 A 00095 B1</b>
<b>Type</b>	Non-polarised power head
<b>Material</b>	Polyamide body
<b>Finishing</b>	Black RAL 9005 ■
<b>Fixing</b>	Plug-in
<b>Insulation class</b>	III
<b>Voltage connection</b>	10 A max · 48 VDC
<b>Note</b>	-

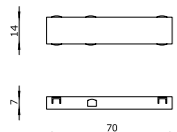

**GIUNTO PASSANTE**  
THROUGH JOINT



CODE COMPOSITION

T048 A 00064 B1

TECHNICAL FEATURES

<b>Code</b>	<b>T048 A 00064 B1</b>
<b>Type</b>	Non-polarised through joint
<b>Material</b>	Polyamide body
<b>Finishing</b>	Black RAL 9005 ■
<b>Fixing</b>	Plug-in
<b>Insulation class</b>	III
<b>Voltage connection</b>	10 A max · 48 VDC
<b>Note</b>	Used to connect two tracks and to guarantee the supply of current.

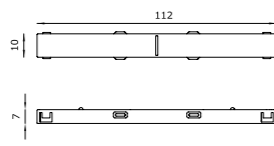

**GIUNTO ANGOLARE  
A 90°**  
90° CORNER JOINT



CODE COMPOSITION

T048 A 00065 B1

TECHNICAL FEATURES

<b>Code</b>	<b>T048 A 00065 B1</b>
<b>Type</b>	Non-polarised 90° corner joint
<b>Material</b>	Polyamide body
<b>Finishing</b>	Black RAL 9005 ■
<b>Fixing</b>	Plug-in
<b>Insulation class</b>	III
<b>Voltage connection</b>	10 A max · 48 VDC
<b>Note</b>	Used to connect two tracks joined at 90° and to guarantee that current reaches the corners.  Light points cannot be installed in the corners.

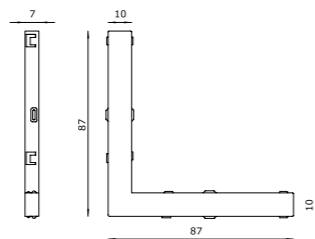

**GIUNTO ANGOLARE A 90°  
SOFFITTO-PARETE**  
CEILING-WALL  
90° CORNER JOINT



CODE COMPOSITION

T048 A 00066 B1

TECHNICAL FEATURES

<b>Code</b>	<b>T048 A 00066 B1</b>
<b>Type</b>	Non-polarised 90° ceiling-wall corner joint
<b>Material</b>	Polyamide body
<b>Finishing</b>	Black RAL 9005 ■
<b>Fixing</b>	Plug-in
<b>Insulation class</b>	III
<b>Voltage connection</b>	10 A max · 48 VDC
<b>Note</b>	Non-polarized angle for ceiling-to-wall connection, used to connect two tracks joined to 90°.  Light points cannot be installed in the corners.

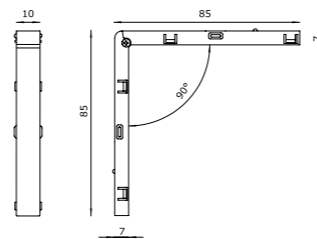

**GIUNTO FLESSIBILE**  
FLEXIBLE JOINT



CODE COMPOSITION

T048 A 00067 B1

TECHNICAL FEATURES

<b>Code</b>	<b>T048 A 00067 B1</b>
<b>Type</b>	Flexible joint
<b>Material</b>	Polyamide body
<b>Finishing</b>	Black RAL 9005 ■
<b>Fixing</b>	Plug-in
<b>Insulation class</b>	III
<b>Voltage connection</b>	10 A max · 48 VDC
<b>Note</b>	Used to connect two tracks installed on different surfaces (ceiling-wall) or to create different angles from 90° and to guarantee power supply.  Light points cannot be installed in the corners.

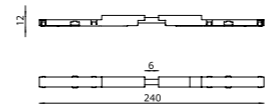

**TRONCHESE**  
CUTTER

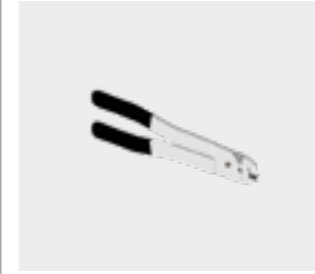

CODE COMPOSITION

TRK 00000 42

TECHNICAL FEATURES

<b>Code</b>	<b>TRK 00000 42</b>
<b>Type</b>	Conductor cutting pliers
<b>Material</b>	-
<b>Finishing</b>	-
<b>Fixing</b>	-
<b>Note</b>	The 1000/2000/3000 mm long tracks are supplied with copper wires already tested with respect to the aluminium in order to prevent the copper terminals from coming into contact with each other, in the case of double power supply, or, to prevent them from touching each other, if closure plugs are used.  If it should be necessary to shorten the length of the track during installation, use the special cutting nippers taking care to pull out the four wires by at least 5 mm to guarantee correct electric distances.

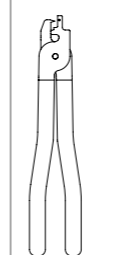

**TAPPO DI CHIUSURA**  
CLOSURE PLUG



CODE COMPOSITION

T048 A 00062 B1

TECHNICAL FEATURES

<b>Code</b>	<b>T048 A 00062 B1</b>
<b>Type</b>	Closure plug
<b>Material</b>	Polyamide body
<b>Finishing</b>	Black RAL 9005 ■
<b>Fixing</b>	By screws (included)
<b>Note</b>	-

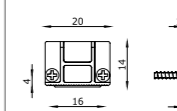

**COVER DI CHIUSURA**  
CLOSING COVER



CODE COMPOSITION

T048 A 00089 B1

TECHNICAL FEATURES

<b>Code</b>	<b>T048 A 00089 B1</b>
<b>Type</b>	Aesthetic closing cover
<b>Material</b>	PMMA
<b>Finishing</b>	Black RAL 9005 ■
<b>Fixing</b>	-
<b>Note</b>	Cover installable at the bottom between the various spotlights, to hide the inside of the track and to allow aesthetic continuity.  Cover length: 3000 mm

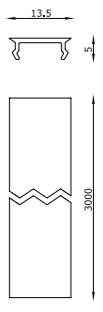

**ALIMENTATORE**  
POWER SUPPLY



CODE COMPOSITION

<b>T048 A 000_00</b>	
	<i>max wattage</i>
<b>96</b>	75W
<b>97</b>	150W
<b>60</b>	240W
example of code composition	T048 A 000 <b>96</b> 00

TECHNICAL FEATURES

Code	<b>T048 A XX</b>
Type	Constant voltage driver
Material	-
Finishing	-
Fixing	-
Insulation class	-
Voltage connection	220-240V 50/60Hz - 48 VDC
Max wattage	75W   150W   240W
Note	-

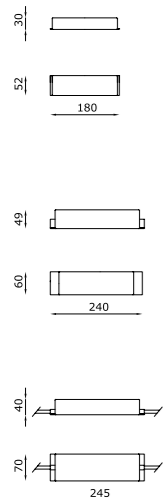

**RIPETITORE**  
**OPTOISOLATO DALI**  
OPTO-INSULATED  
REPEATER DALI



CODE COMPOSITION

<b>T048 A 00078 00</b>	
------------------------	--

TECHNICAL FEATURES

Code	<b>T048 A 00078 00</b>
Type	DALI signal repeater and regenerator
Material	-
Finishing	-
Fixing	-
Insulation class	-
Voltage connection	48 VDC
Max wattage	-
Note	The device makes the <b>DALI FELV</b> signal compatible with the Buzzi & Buzzi 48V track system, making it <b>SELV</b> .

