

# ECLA

INCASSO CON VETRO RETROCESSO  
E MASSIMA INVISIBILITÀ  
RECESSED FIXTURE WITH RETRACTED GLASS  
AND HIGHEST INVISIBILITY





## Ecla



### OTHER AVAILABLE CODES

6268.Z.27.AC	<i>lens</i>	40°
	<i>light colour</i>	2700K
6268.Z.40.AC	<i>lens</i>	40°
	<i>light colour</i>	4000K
emergency		
6213.AC 4 R 40 E _ WD	<i>lens</i>	40°
	<i>light colour</i>	
	27	2700K
	30	3000K
	40	4000K
example of code composition		
6213.AC 4 R 40 E 30 WD		

### TECHNICAL FEATURES

Code	6268.Z.AC	6213.AC XX emergency
Type	Downlight 90° 	Downlight 90° 
Material	AC: AirCoral®	AC: AirCoral®
Absorption capacity*	2.72 m²	2.72 m²
Weight	1.2 Kg	1.7 Kg
Mounting	Ceiling recessed	Ceiling recessed
IP rating	IP40	IP40
Insulation class	III	III
Control gear	Remote constant current electronic driver (not included)	Remote driver (not included), inverter (included)
Dimensions	A: 120 mm; B: 130 mm	A: 120 mm; B: 150 mm
Cut out for plasterboard	Ø 170 mm	Ø 170 mm
Lamp type	LED 500 mA  Vf: 18 VDC	LED 500 mA  Vf: 18 VDC
Lamp wattage	1 × 9W	1 × 9W
Luminous efficacy	1 × 1125 lm - 3000K	1 × 1125 lm - 3000K
Light distribution	Wide beam 40°	Wide beam 40°
Fitting	-	-
Light colour	White 3000K	White 3000K White 2700K I 4000K
Light hole	Ø 100 mm	Ø 100 mm
Voltage connection	By driver (optional)	220-240V · 50/60Hz
CRI	>90	>90
Emergency	-	1 hour
Energy efficiency class	A++	A++
Note	Extra white satin glass. Frosted glass recessed 30 mm into the ceiling.  Other available light colours: 2700K, 4000K.	Extra white satin glass. Frosted glass recessed 30 mm into the ceiling..

### OPTIONAL

ON/OFF driver	cod. H8500.E	cod. H8500.E
Trailing and leading edge driver	cod. DRV0000163	cod. DRV0000163
DALI dimmable LED driver	cod. DRV0000029	cod. DRV0000029
PUSH dimmable LED driver	cod. DRV0000026	cod. DRV0000026
PUSH/1-10V/DALI dimmable LED driver	cod. DRV0000093	cod. DRV0000093
Brick box	cod. BR6268LT	cod. BR6213LT

For further info and other available drivers please see page 474

\* The absorption capacity per m² calculated by the American organization TCNA (Tile Council of North America) is measured for an average room of 2.7 m in height and therefore expressed in m²

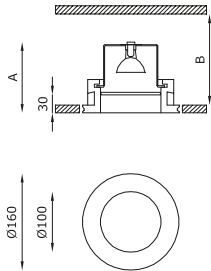

Ecla



TECHNICAL FEATURES

Code	6265.AC	6263.AC
Type	Downlight 90°	Downlight 90°
Material	AC: AirCoral®	AC: AirCoral®
Absorption capacity*	2.72 m²	2.72 m²
Weight	1 Kg	1 Kg
Mounting	Ceiling recessed	Ceiling recessed
IP rating	IP40	IP40
Insulation class	III	I
Control gear	Electronic transformer (not included)	-
Dimensions	A: 120 mm; B: 150 mm	A: 135 mm; B: 150 mm
Cut out for plasterboard	Ø 170 mm	Ø 170 mm
Lamp type	QR CB 51	QPAR 16
Lamp wattage	1 × 50W max	1 × 50W max
Luminous efficacy	-	-
Light distribution	-	-
Fitting	GU5.3	GU10
Light colour	-	-
Light hole	Ø 100 mm	Ø 100 mm
Voltage connection	By driver (optional)	220-240V · 50/60Hz
CRI	-	-
Emergency	-	-
Energy efficiency class	A	A
Note	Extra white satin glass. Frosted glass recessed 30 mm into the ceiling.	Extra white satin glass. Frosted glass recessed 30 mm into the ceiling.

OPTIONAL

Trailing and leading edge driver	cod. H8060.LED	-
Kit LED dimmable	cod. 0008KIT	cod. 0009KIT
Brick box	cod. BR6265LT	cod. BR6263LT

For further info and other available drivers please see page 474

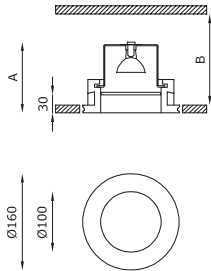

Ecla Dim To Warm



TECHNICAL FEATURES

Code	6215.AC 4 R 40 E 98 WD
Type	Downlight 90°
Material	AC: AirCoral®
Absorption capacity*	2.72 m²
Weight	1.2 Kg
Mounting	Ceiling recessed
IP rating	IP40
Insulation class	III
Control gear	Remote ON/OFF driver** (not included)
Dimensions	A: 120 mm; B: 130 mm
Cut out for plasterboard	Ø 170 mm
Lamp type	LED 350 mA
Lamp wattage	1 × 6W
Luminous efficacy	1 × 600 lm (from 1800K up to 3000K)
Light distribution	Wide beam 40°
Fitting	-
Light colour	Dimming range 1800/3000K
Light hole	Ø 100 mm
Voltage connection	By driver (optional)
CRI	>90
Emergency	-
Energy efficiency class	A++
Note	Extra white satin glass. Frosted glass recessed 30 mm into the ceiling.
	**Ecla Dim To Warm requires dimming: amplitude (AM) dim to warm wide range input voltage.

OPTIONAL

Amplitude DALI dimmable LED driver	H8350DA.AM
Amplitude PUSH dimmable LED driver	H8350PH.AM
Brick box	cod. BR6215LT

For further info and other available drivers please see page 474