

ECLA



INCASSO CON VETRO RETROCESSO,
MASSIMA INVISIBILITÀ.

Un prodotto invisibile, un design discreto, una luce unica per infinite soluzioni progettuali: Ecla, è un prodotto da interni in AirCoral®, un incasso a scomparsa totale per installazione a soffitto di cartongesso o laterizio. L'armonia creata dalla perfetta combinazione tra tecnologia ed eleganza è la caratteristica fondante dell'Ecla. Un unico prodotto, per 3 diversi tipi di sorgenti luminose, la risposta a qualsiasi esigenza progettuale.

RECESSED FITTING WITH REAR GLASS,
MAXIMUM INVISIBILITY.

An invisible product, a discreet design, a unique light for infinite project solutions: Ecla, is a totally disappearing indoor recessed luminaire made of AirCoral®, installable on plasterboard or brick ceilings. The harmony created by the perfect combination of technology and elegance, is the main features of Ecla. A unique line, for 3 different lamp types, the answer to any design need.

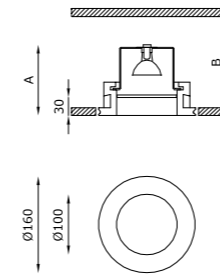

TECHNICAL FEATURES

Code	6268.Z.AC	6213.Z.AC	6265.AC	6263.AC
Type	Downlight 90° 	Downlight 90° 	Downlight 90° 	Downlight 90°
Material	AC: AirCoral®	AC: AirCoral®	AC: AirCoral®	AC: AirCoral®
Absorption capacity*	2.72 m²	2.72 m²	2.72 m²	2.72 m²
Weight	1.2 Kg	1.7 Kg	1 Kg	1 Kg
Mounting	Ceiling recessed	Ceiling recessed	Ceiling recessed	Ceiling recessed
IP rating	IP40	IP40	IP40	IP40
Insulation class	III	III	III	I
Control gear	Constant current electronic driver (not included)	Constant current electronic driver	Electronic transformer (not included)	-
Dimensions	A: 120 mm; B: 130 mm	A: 120 mm; B: 150 mm	A: 120 mm; B: 150 mm	A: 135 mm; B: 150 mm
Cut out for plasterboard	Ø 170 mm	Ø 170 mm	Ø 170 mm	Ø 170 mm
Lamp type	LED 500 mA Vf: 18 VDC	LED 500 mA Vf: 18 VDC	QR CB 51 	QPAR 16
Lamp wattage	1 x 9W	1 x 9W	1 x 50W max	1 x 50W max
Luminous efficacy	1125 lm - 3000K	1125 lm - 3000K	-	-
Light distribution	Wide beam 40°	Wide beam 40°	-	-
Fitting	-	-	GU5.3	GU10
Light colour	White 3000K White 2700K 4000K (on request)	White 3000K White 2700K 4000K (on request)	-	-
Light hole	Ø 100 mm	Ø 100 mm	Ø 100 mm	Ø 100 mm
Voltage connection	By driver (optional)	220-240V · 50/60Hz	By driver (optional)	220-240V · 50/60Hz
CRI	>90	>90	-	-
Emergency	-	1 hour	-	-
Energy efficiency class	A++	A++	A	A
Note	Extra white satin glass. Frosted glass recessed 30 mm into the ceiling. On request available dimmable PUSH or DALI.	Extra white satin glass. Frosted glass recessed 30 mm into the ceiling.	Extra white satin glass. Frosted glass recessed 30 mm into the ceiling.	Extra white satin glass. Frosted glass recessed 30 mm into the ceiling.

OPTIONAL ACCESSORIES

product code	optional code	description	info
6268.Z.AC	H8500.E	Constant current electronic driver	Suitable for n°2 code 6268.Z.AC - 500 mA
	H8500.B	Constant current electronic driver	Suitable for n°1 code 6268.Z.AC - 500 mA
	BR6268LT	Brick box	Dimensions L: 195 mm; W: 160 mm; D: 160 mm (instructions on page 502)
6265.AC	H8060.LED	Dimmable electronic transformer	Max watt 60W Volts · Hz 230/12V · 50/60Hz
	0008KIT	Kit LED dimmable	Bulb 7W · 12V
	BR6265LT	Brick box	Dimensions L: 195 mm; W: 160 mm; D: 160 mm (instructions on page 502)
6263.AC	0009KIT	Kit LED dimmable	Bulb 6W · 220-240V
	BR6263LT	Brick box	Dimensions L: 195 mm; W: 160 mm; D: 160 mm (instructions on page 502)

* The absorption capacity per m² calculated by the American organization TCNA (Tile Council of North America) is measured for an average room of 2.7 m in height and therefore expressed in m²



Armani Casa - Maçka Residences - ph. E. Abrate - Istanbul