

# B30

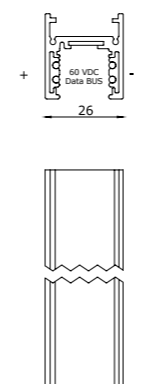

- matt white RAL 9016 painted
- matt black RAL 9005 painted

## LIGHT MODULES

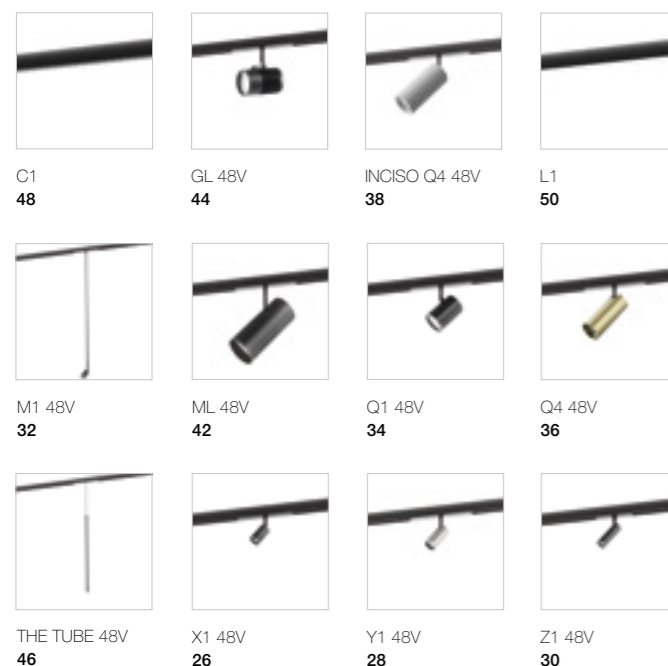

Sistema di illuminazione da interno, per installazione a sospensione e a superficie. Binario e corpi sono gestibili con sistemi di controllo remoto DALI e 1-10V. Il profilo ha lunghezza compresa fra 1 m e 3 m, estruso in alluminio con due finiture bianco e nero, è dotato di conduttori 48V. B30 a 48V si completa a sua volta con tutti i prodotti di illuminazione Buzzi & Buzzi dotati di attacchi con un'elettronica integrata.

*Lighting system for interiors, for pendant and surface installation. Track and structures can be managed by DALI and 1-10V remote control systems. The length of the profile is between 1 and 3 m, extruded in aluminium with two white and black finishes, it is fitted with 48V wires. The 48V B30 is in turn completed with all the Buzzi and Buzzi lighting products equipped with sockets with integrated electronics.*

## CODE COMPOSITION

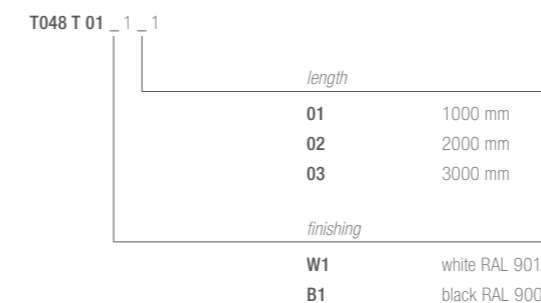

example of code composition T048 T 01 **W1** 1 01 1

## TECHNICAL FEATURES

<b>Code</b>	<b>T048 T 01 XX</b>
<b>Type</b>	Low voltage track
<b>Material</b>	Aluminum
<b>Finishing</b>	White RAL 9016   Black RAL 9005
<b>Weight</b>	-
<b>Mounting</b>	Surface   Suspension
<b>IP rating</b>	-
<b>Insulation class</b>	III
<b>Control gear</b>	Remote power supply (not included)
<b>Dimensions</b>	A: 1000 mm   2000 mm   3000 mm
<b>Cut out for plasterboard</b>	-
<b>Voltage connection</b>	48 VDC
<b>Circuits</b>	2 x ±15 A · 48 VDC   1 x ±15 A · 48 VDC + D+/D-
<b>Note</b>	B30 is a 48V powered electrical system and limited to a maximum current of 15 A.  The supply connectors, plugs and further fixture accessories must be ordered separately.  Any 90° connector must be ordered separately to ensure electric continuity in the corners.  Light points cannot be installed in the corners.  For ceiling or wall mounting, it's possible to fix the rail directly with self-tapping countersunk head screws, while the suspended installation requires the purchase of the specific kit.

TESTATA  
DI ALIMENTAZIONE

POWER HEAD



CODE COMPOSITION

T048 A 000_		
	<i>finishing</i>	
	<b>01 W1</b>	white RAL 9016
	<b>02 B1</b>	black RAL 9005

example of code composition T048 A 000**01 W1**

TECHNICAL FEATURES

Code	<b>T048 A XX</b>
Type	Non-polarised power head
Material	Polycarbonate
Finishing	White RAL 9016 Black RAL 9005
Fixing	Plug-in
Insulation class	III
Voltage connection	15 A max · 48 VDC
Note	-

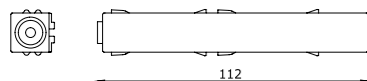

GIUNTO PASSANTE

THROUGH JOINT



CODE COMPOSITION

T048 A 000_		
	<i>finishing</i>	
	<b>03 W1</b>	white RAL 9016
	<b>04 B1</b>	black RAL 9005

example of code composition T048 A 000**03 W1**

TECHNICAL FEATURES

Code	<b>T048 A XX</b>
Type	Non-polarised through joint
Material	Polycarbonate
Finishing	White RAL 9016 Black RAL 9005
Fixing	Plug-in
Insulation class	III
Voltage connection	15 A max · 48 VDC
Note	Used to connect two tracks and to guarantee the supply of current.

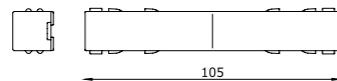

GIUNTO ANGOLARE A 90°

90° CORNER JOINT



CODE COMPOSITION

T048 A 000_		
	<i>finishing</i>	
	<b>05 W1</b>	white RAL 9016
	<b>06 B1</b>	black RAL 9005

example of code composition T048 A 000**05 W1**

TECHNICAL FEATURES

Code	<b>T048 A XX</b>
Type	Non-polarised 90° corner joint
Material	Polycarbonate
Finishing	White RAL 9016 Black RAL 9005
Fixing	Plug-in
Insulation class	III
Voltage connection	15 A max · 48 VDC
Note	Used to connect two tracks joined at 90° and to guarantee that current reaches the corners. Light points cannot be installed in the corners.

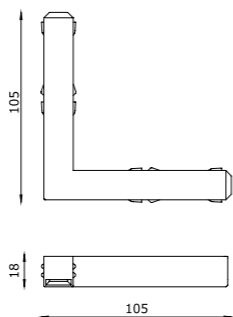

GIUNTO FLESSIBILE

FLEXIBLE JOINT



CODE COMPOSITION

T048 A 000_		
	<i>finishing</i>	
	<b>07 W1</b>	white RAL 9016
	<b>08 B1</b>	black RAL 9005

example of code composition T048 A 000**07 W1**

TECHNICAL FEATURES

Code	<b>T048 A XX</b>
Type	Flexible joint
Material	Polycarbonate
Finishing	White RAL 9016 Black RAL 9005
Fixing	Plug-in
Insulation class	III
Voltage connection	15 A max · 48 VDC
Note	Used to connect two tracks installed on different surfaces (ceiling-wall) or to create different angles from 90° and to guarantee power supply. Light points cannot be installed in the corners.

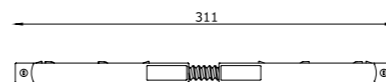

TAPPO DI CHIUSURA

CLOSURE PLUG

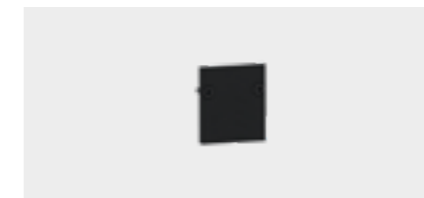

CODE COMPOSITION

T048 A 000_		
	<i>finishing</i>	
	<b>09 W1</b>	white RAL 9016
	<b>10 B1</b>	black RAL 9005

example of code composition T048 A 000**09 W1**

TECHNICAL FEATURES

Code	<b>T048 A XX</b>
Type	Closure plug
Material	Polycarbonate
Finishing	White RAL 9016 Black RAL 9005
Fixing	By screws (included)
Note	-

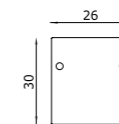

TAPPO DI CHIUSURA FORATO

HOLED CLOSURE PLUG

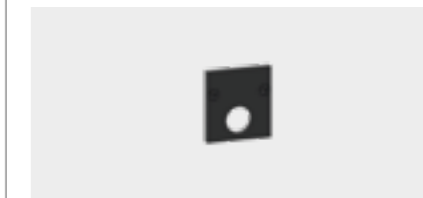

CODE COMPOSITION

T048 A 000_		
	<i>finishing</i>	
	<b>13 W1</b>	white RAL 9016
	<b>14 B1</b>	black RAL 9005

example of code composition T048 A 000**13 W1**

TECHNICAL FEATURES

Code	<b>T048 A XX</b>
Type	Closure plug with hole for cable passage
Material	Polycarbonate
Finishing	White RAL 9016 Black RAL 9005
Fixing	By screws (included)
Note	-

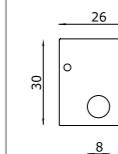

NEW

**TRONCHESE**  
CUTTER

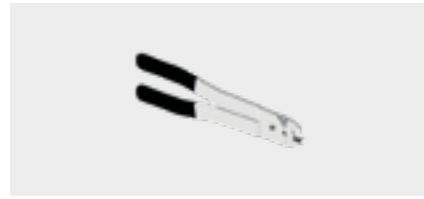

CODE COMPOSITION

TRK 00000 42

TECHNICAL FEATURES

<b>Code</b>	<b>TRK 00000 42</b>
<b>Type</b>	Conductor cutting pliers
<b>Material</b>	-
<b>Finishing</b>	-
<b>Fixing</b>	-
<b>Note</b>	The 1000/2000/3000 mm long tracks are supplied with copper wires already tested with respect to the aluminium in order to prevent the copper terminals from coming into contact with each other, in the case of double power supply, or, to prevent them from touching each other, if closure plugs are used.
	If it should be necessary to shorten the length of the track during installation, use the special cutting nippers taking care to pull out the four wires by at least 5 mm to guarantee correct electric distances.

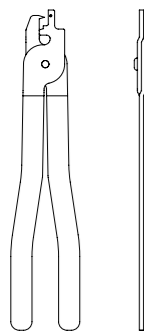

**COVER PER GIUNTO A 90°**  
90° CORNER JOINT COVER



CODE COMPOSITION

<b>T048 A 000_</b>	<i>finishing</i>	
	<b>19 W1</b>	white RAL 9016
	<b>20 B1</b>	black RAL 9005
<b>example of code composition</b>	T048 A 000 <b>19 W1</b>	

TECHNICAL FEATURES

<b>Code</b>	<b>T048 A XX</b>
<b>Type</b>	90° corner joint cover
<b>Material</b>	Aluminum body, steel bracket
<b>Finishing</b>	White RAL 9016  Black RAL 9005 
<b>Fixing</b>	By screws
<b>Note</b>	The 90° corner joint allows the mechanical connection of the tracks, forming a 90° angle, without cutting them at 45°.

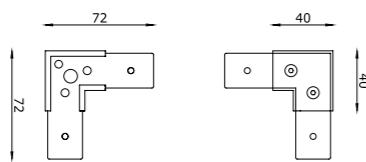

**KIT SOSPENSIONE E GIUNZIONE**  
SUSPENSION AND JUNCTION KIT



CODE COMPOSITION

T048 A 00024 00

TECHNICAL FEATURES

<b>Code</b>	<b>T048 A 00024 00</b>
<b>Type</b>	Suspension and junction kit
<b>Material</b>	Steel
<b>Finishing</b>	-
<b>Fixing</b>	-
<b>Note</b>	Kit composed of metallic spherical rose, steel cable Ø 1.5 mm and automatic screw coupling attached to the bracket.
	Cable length 3 m (on request different lengths are available).
	Position the fixture kit with an inter-axis of 450 mm for a max capacity of 50 kg, or 900 mm for max 25 kg.

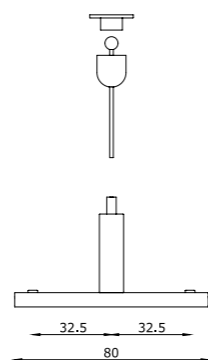

**ALIMENTATORE**  
POWER SUPPLY



CODE COMPOSITION

T048 A 00060 00

TECHNICAL FEATURES

<b>Code</b>	<b>T048 A 00060 00</b>
<b>Type</b>	Constant voltage driver
<b>Material</b>	-
<b>Finishing</b>	-
<b>Fixing</b>	-
<b>Insulation class</b>	-
<b>Voltage connection</b>	220-240V · 50/60Hz · 48 VDC
<b>Max wattage</b>	240W max
<b>Note</b>	-

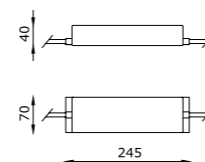



**CASSETTA PER ALIMENTATORE**  
SUPPLY BOX



CODE COMPOSITION

<b>T048 A 000_</b>	<i>finishing</i>	
	<b>58 W1</b>	white RAL 9016
	<b>59 B1</b>	black RAL 9005
<b>example of code composition</b>	T048 A 000 <b>58 W1</b>	

TECHNICAL FEATURES

<b>Code</b>	<b>T048 A XX</b>
<b>Type</b>	48V supply box
<b>Material</b>	Steel
<b>Finishing</b>	White RAL 9016  Black RAL 9005 
<b>Fixing</b>	By screws
<b>Insulation class</b>	-
<b>Voltage connection</b>	-
<b>Note</b>	The purpose of the supply box attached to the surface is to house the driver in all those situations in which a remote driver cannot be used.

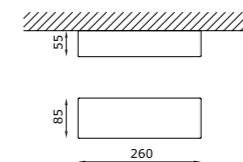



**DALI GATE 48V**  
DALI GATE 48V



CODE COMPOSITION

<b>T048 A 000_</b>	<i>finishing</i>	
	<b>77 W1</b>	white
	<b>73 B1</b>	black
<b>example of code composition</b>	T048 A 000 <b>77 W1</b>	

TECHNICAL FEATURES

<b>Code</b>	<b>T048 A XX</b>
<b>Type</b>	Dali Gate Bluetooth®
<b>Material</b>	-
<b>Finishing</b>	White  Black 
<b>Fixing</b>	-
<b>Insulation class</b>	-
<b>Voltage connection</b>	220-240V · 50/60Hz · 48 VDC
<b>Max wattage</b>	6W
<b>Note</b>	DALI GATE Casambi has been designed and developed to control lamps with DALI drivers using the Casambi app, installed on mobile devices. The Casambi app communicates with DALI GATE by means of Bluetooth® technology. The received signal is then adequately interpreted to generate the corresponding command on the DALI bus.
	Up to 64 lamps (control gear) can be programmed, assigning them to up to 8 groups.
	It must be the only DALI master on the bus (MONO MASTER bus)

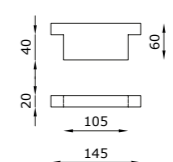

NEW