



VIRTUS DIRECT IP65



TECNOCEMENTO E ALLUMINIO PER RESISTENZA NEL TEMPO.

Virtus Direct IP65 è un apparecchio per esterni a parete dal design elegante, lineare: un'applique che parla di purezza, di forme e di luce che, insieme alle caratteristiche del materiale DurCoral®, danno vita a soluzioni uniche in grado di integrarsi con l'ambiente esterno. Una luce diretta, che crea precise atmosfere luminose lungo i percorsi, i punti di accesso e le facciate degli edifici su cui il prodotto viene installato.

L'illuminazione definisce gli spazi, si pone al servizio dei materiali, dei volumi, dei colori, consente di percepire gli ambienti e di vivere, ogni volta, emozioni diverse. Virtus Direct IP65 ha un'anima interna in alluminio pressofuso, un diffusore in vetro satinato, oltre a guarnizioni in silicone e viti interne in acciaio inox che lo rendono ideale per ambienti esterni.

TECHNO-CEMENT AND ALUMINIUM FOR LONG-LASTING RESISTANCE.

Virtus Direct IP65 is a wall lighting device for outdoor use with an elegant and linear design: an applique that speaks of purity, shapes and light which, together with the features of DurCoral®, give life to unique solutions able to perfectly integrate themselves inside the external environment. A direct light that creates precise bright atmospheres alongside paths, access points and façades of the buildings it is installed on. Lighting defines spaces, putting itself at the service of materials, volumes, colours, allowing the perception of spaces and ever different emotions. Virtus Direct IP65 has an internal soul in die-cast aluminium, a satin-glass diffuser, silicone gaskets and internal inox-steel screws which make it the ideal product for outdoor environments.

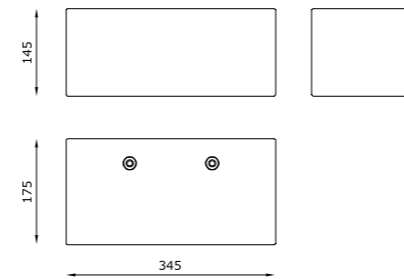

TECHNICAL FEATURES

Code	3064.64.DC	3068.68.DC
Type	Wall lamp 	Wall lamp 
Material	DC: DurCoral®	DC: DurCoral®
Weight	8.6 Kg	8.6 Kg
Mounting	Wall mounting	Wall mounting
IP rating	IP65	IP65
Insulation class	I	I
Control gear	Conventional ballast	Constant voltage LED driver
Cut out for plasterboard	-	-
Lamp type	TC-D 	LED 24V 
Lamp wattage	2 x 26W	1 x 13W
Luminous efficacy	-	1700 lm
Light distribution	-	Wide beam 120°
Fitting	G24d-3	-
Light colour	-	White 3000K White 2700K 4000K (on request)
Light hole	-	-
Voltage connection	220-240V · 50/60Hz	220-240V · 50/60Hz
CRI	-	>80
Emergency	-	-
Energy efficiency class	A	A++
Note	Extra white frosted glass diffuser. Aluminum reflector.	Extra white frosted glass diffuser. Aluminum reflector.